

Geetha Shishu Shikshana Sangha(R),  
Siddartha Nagar, Mysuru

ANNEXURE - 1

PLAN SHOWING THE GSSS INSTITUTE OF ENGINEERING & TECHNOLOGY FOR WOMEN SITUATED IN SURVEY NO - 21(Part), 24/2A (Part), 27/4(Part) ,27/5(Part)& 28(Part) SITUATED IN METAGALLY INDUSTRIAL AREA, K.R.S.ROAD,IN MYSORE.

ARCHITECT :  
**Desirazu Associates**  
Architecture Planning Interiors  
#6,8th Main,Paramahansa Road,Yadavgir,  
Mysore-570020  
Mysore Chennai Mysuru

Drawing no: GSSS-A001/19 REV2

INDEX

[Symbol]	Boundary line
[Symbol]	Tree
[Symbol]	Asphalt Road
[Symbol]	Existing Buildings
[Symbol]	Open Drain
[Symbol]	Box Drain
[Symbol]	Temporary Bench Mark
[Symbol]	Electrical pole
[Symbol]	Transformer
[Symbol]	ManHole Chamber
[Symbol]	Steps
[Symbol]	Pathway
[Symbol]	Sump
[Symbol]	Street Light
[Symbol]	Gate
[Symbol]	Ramp

Temporary Bench Mark Table			
Sl. No	Stationing	Reduced Level	Remarks
750	47713.490	102.128	TBM01
751	47713.872	104.708	TBM02
13990	47696.876	99.881	TBM03
14000	47749.868	107.847	TBM04
14001	47746.488	107.861	TBM05
14002	47768.488	106.083	TBM06
14003	47788.978	106.485	TBM07
14004	47698.717	98.879	TBM08
14005	47749.868	107.847	TBM09
14006	47746.488	107.861	TBM10
14007	47768.488	106.083	TBM11
14008	47788.978	106.485	TBM12
14009	47698.717	98.879	TBM13
14010	47749.868	107.847	TBM14
14011	47746.488	107.861	TBM15
14012	47768.488	106.083	TBM16
14013	47788.978	106.485	TBM17
14014	47698.717	98.879	TBM18

WTP Area	
Sl. No	Name
1	Pump House
2	Sludge Pit
3	Filter
4	Clarified
5	Clarified Water Sump
6	Aeration Tank
7	Equalisation Tank

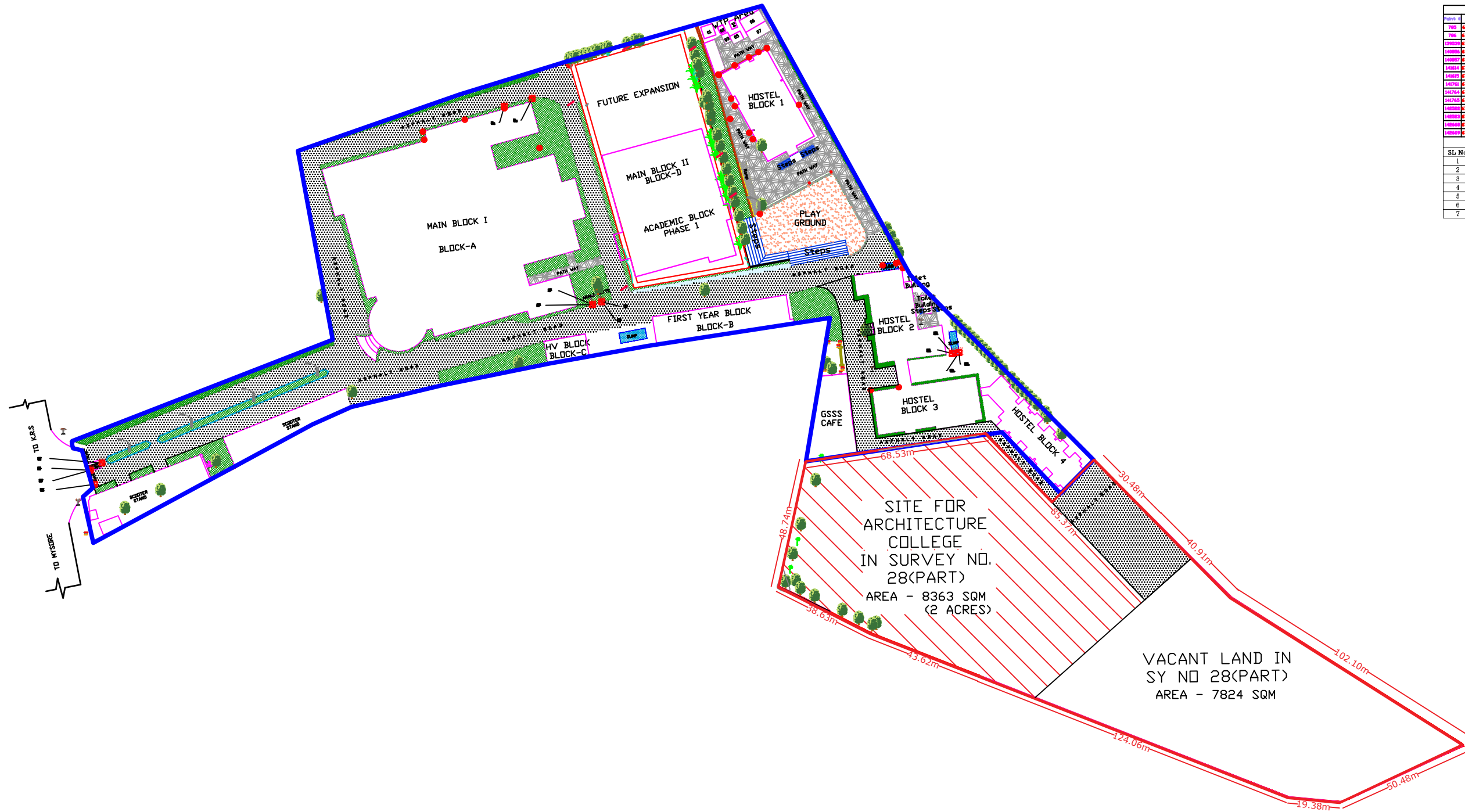

Total Area of Boundary :  
46619 Sq. mtrs.  
&  
11 Acres 22 Guntas

Checked by	PROJECT MANAGER	DATE: 24/02/2019
Drawn by	DESIGNER	
Scale	Scale 1 : 6225	

- TOTAL SITE AREA IN SURVEY NO - 21(Part), 24/2A (Part), 27/4(Part) ,27/5(Part)& 28(Part) : 11.22 ACRES
- LAND UTILISED FOR ENGINEERING AND TECHNOLOGY PROGRAM IN SURVEY NO - 21(Part), 24/2A (Part), 27/4(Part), 27/5(Part) & 28(Part) : 7.22 ACRES
- VACANT LAND IN SURVEY NO - 28(Part) : 4 ACRES
- LAND RESERVED FOR ARCHITECTURE COLLEGE IN SURVEY NO - 28 (Part): 2 ACRES

ANNEXURE - 2

Geetha Shishu Shikshana Sangha(R),  
Siddartha Nagar, Mysuru

PLAN SHOWING THE REMAINING 4 ACRES OF VACANT LAND SITUATED IN SURVEY NO - 28(Part) IN GSSS INSTITUTE OF ENGINEERING AND TECHNOLOGY FOR WOMEN , METGALLI INDUSTRIAL AREA, K.R.S.ROAD, MYSORE.

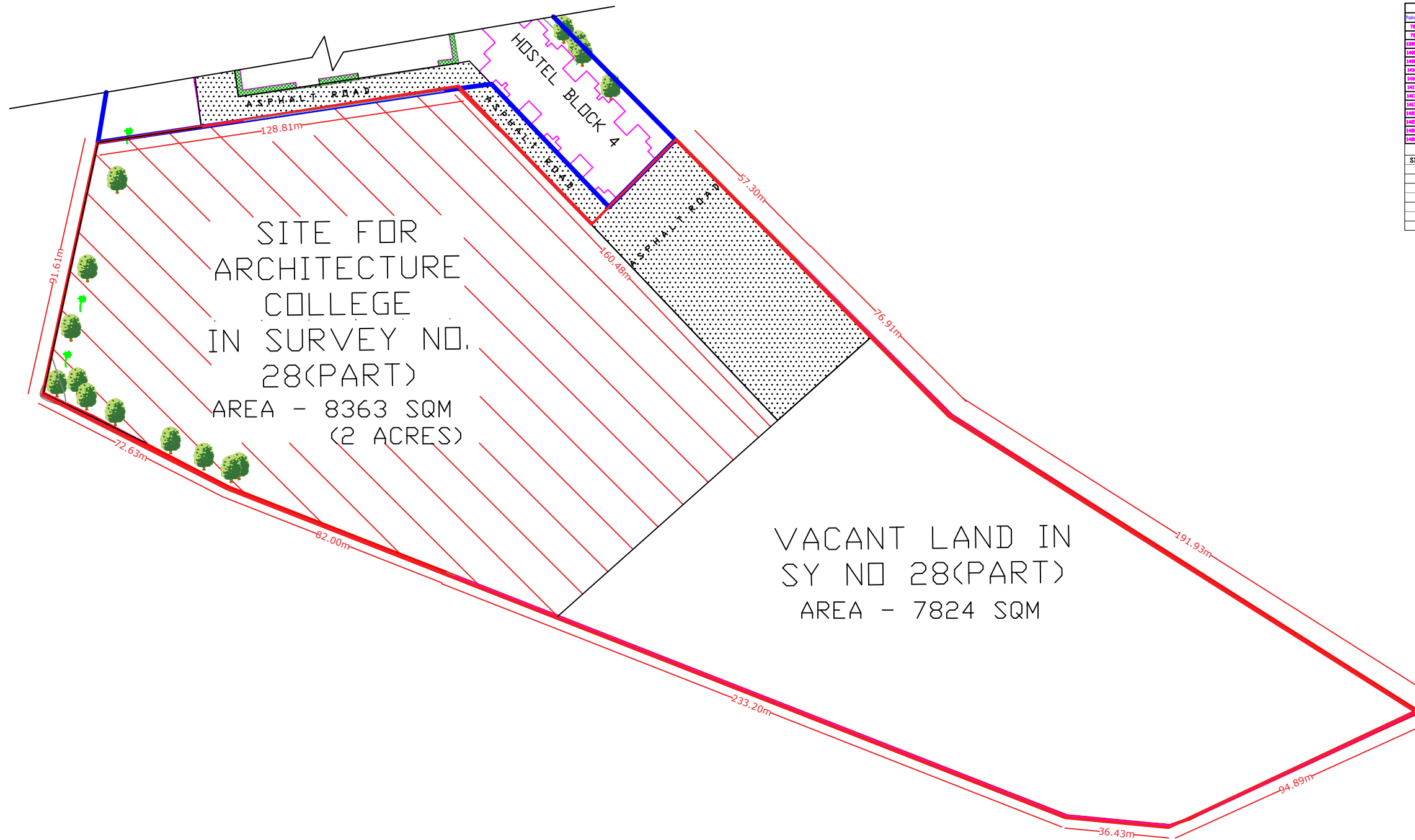

Station	Easting	Northing	Remarks
780	47713.490	10748.000	128.128
781	47713.872	10748.000	164.798
13900	47698.870	10748.000	99.881
14000	47749.880	10748.000	107.847
14000	47746.480	10748.000	107.861
14000	47700.480	10748.000	104.883
14000	47700.370	10748.000	104.883
14070	47698.717	10748.000	104.879
14070	47749.880	10748.000	107.848
14070	47746.480	10748.000	107.862
14070	47700.480	10748.000	104.887
14070	47698.870	10748.000	104.892
14000	47698.717	10748.000	104.879

ARCHITECT :  
**Desirazu Associates**  
Architecture Planning Interiors  
#6, 8th Main, Paramahansa Road, Yadavgir,  
Mysore-570020  
Mysore Chennai Mysur

Drawing no: GSSS-A002/19 REV2

**INDEX**

[Symbol]	Boundary line
[Symbol]	Tree
[Symbol]	Asphalt Road
[Symbol]	Existing Buildings
[Symbol]	Open Drain
[Symbol]	Box Drain
[Symbol]	Temporary Bench Mark
[Symbol]	Electrical pole
[Symbol]	Transformer
[Symbol]	ManHole Chamber
[Symbol]	Lawn
[Symbol]	Steps
[Symbol]	Pathway
[Symbol]	Sump
[Symbol]	Street Light
[Symbol]	Gate
[Symbol]	Ramp

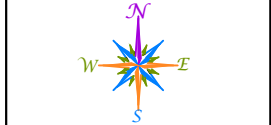

Total Area of Boundary :  
46619 Sq. mtrs.  
&  
11 Acres 22 Guntas

G.S.S.S. INSTITUTE OF ENGINEERING & TECHNOLOGY FOR WOMEN,  
METGALLI INDUSTRIAL AREA, K.R.S. ROAD, MYSORE.

DESIGNED BY P.P. Ramiah	<b>MOUSHI CONSULTANTS</b> P. P. RAMIAH 14, Ganga Vinayaka, Kannur Street, Mysore, Karnataka-570022 Ph: 0821 2340000, 98480 0408 www.moushi.com	DATE: 24/02/2019 SHEET NO: 1 OF 1
----------------------------	--	--------------------------------------

Scale 1 : 6225

- VACANT LAND IN SURVEY NO - 28(Part) : 4 ACRES
- LAND RESERVED FOR ARCHITECTURE COLLEGE IN SURVEY NO - 28 (Part): 2 ACRES

# PROPOSED SoAW BLOCK

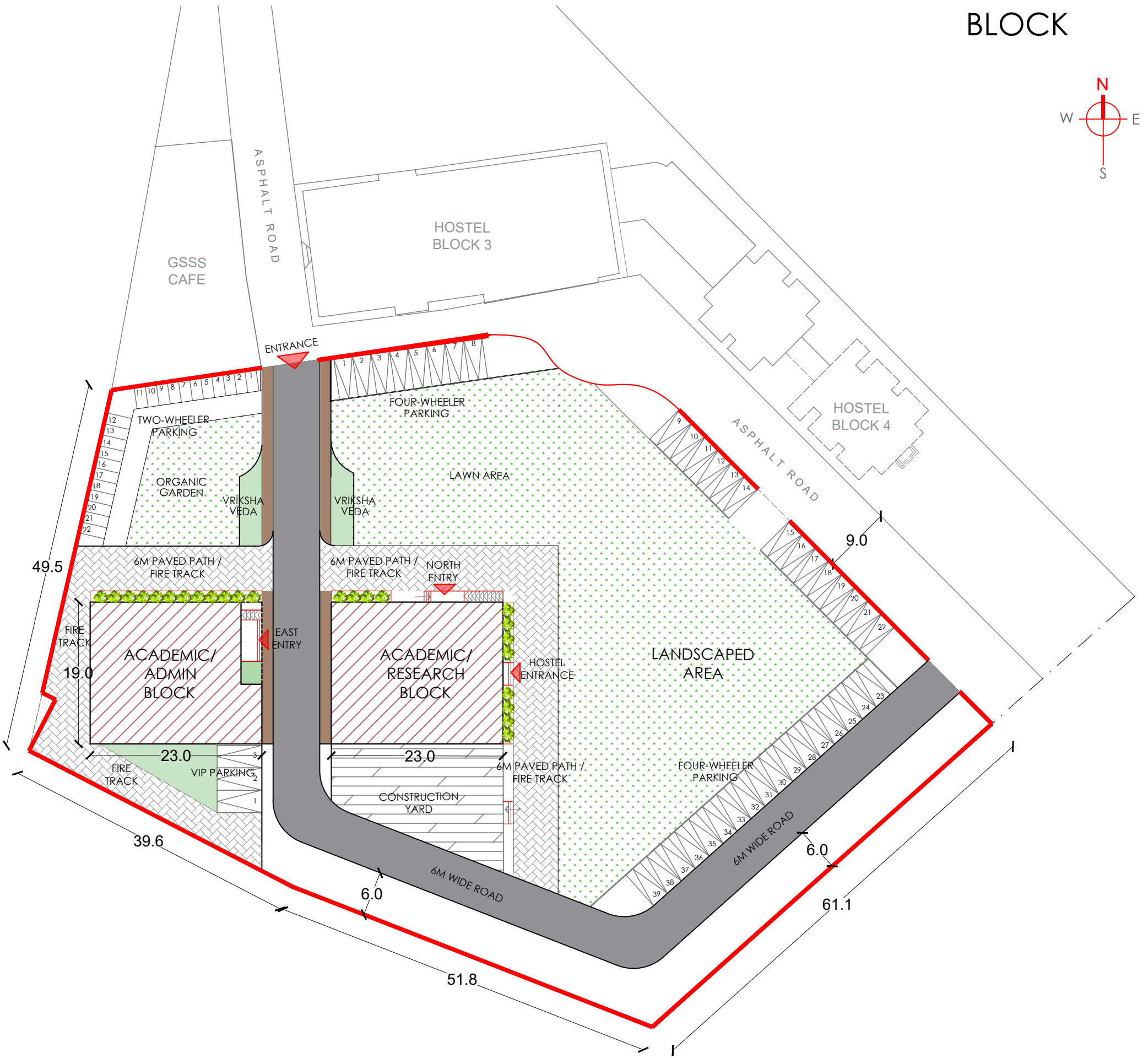
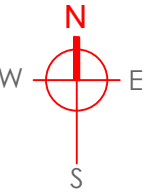

## SITE PLAN

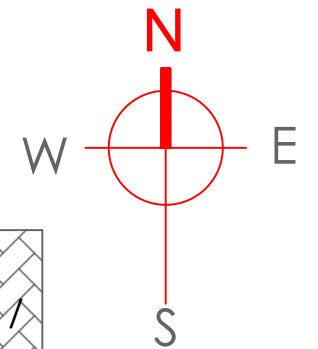

# GROUND FLOOR PLAN

**Desirazu Associates**

Architecture      Planning      Interiors

#6 ,6th Main,Paramahansa Road,Yadavgiri,  
Mysore-570020

Mysore      Chennai      Muscat



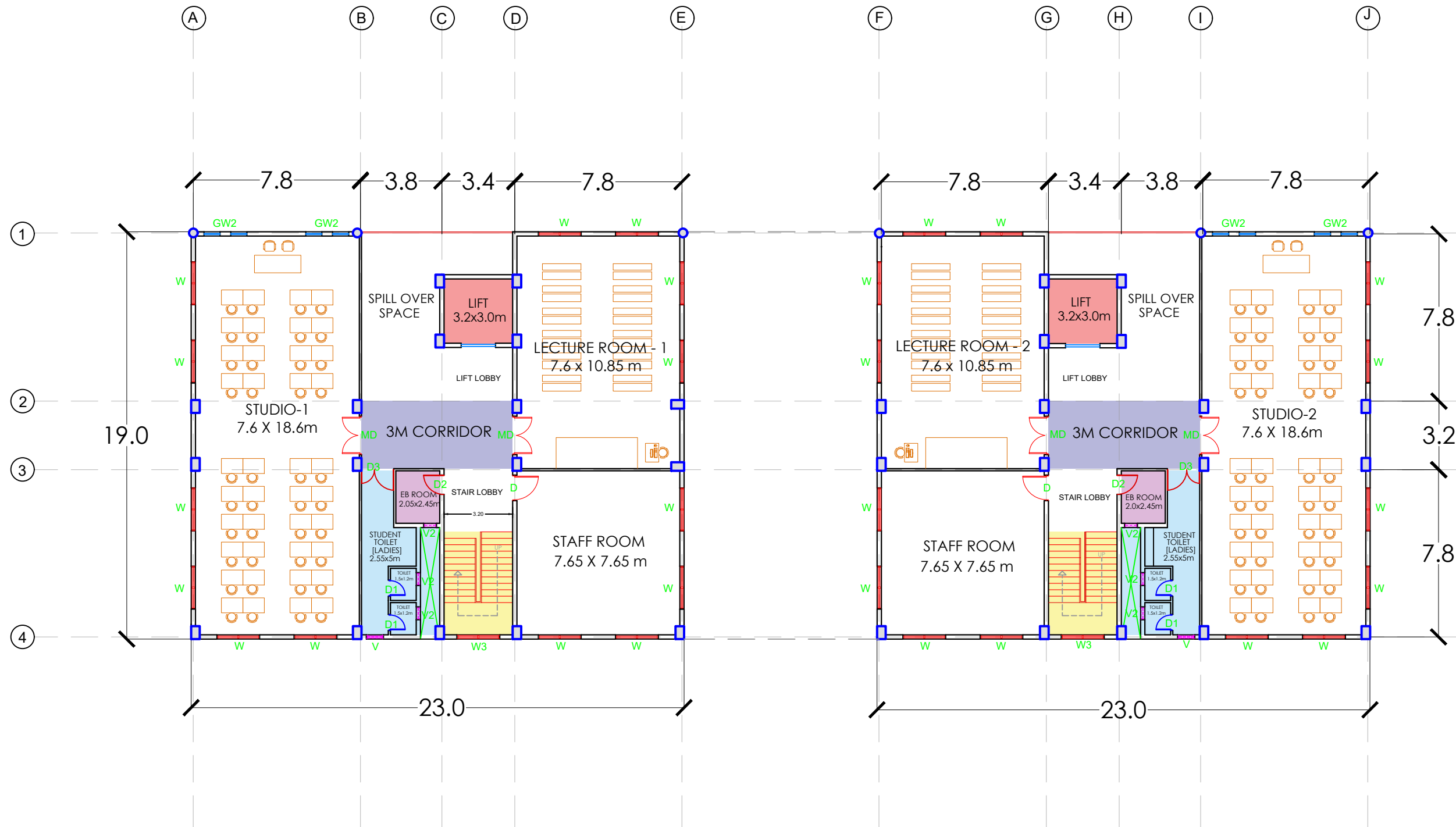
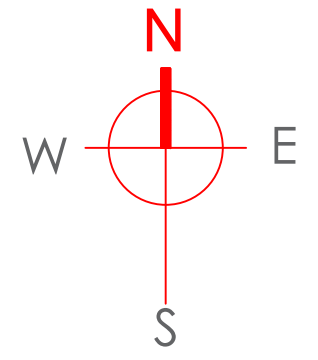

# FIRST FLOOR PLAN

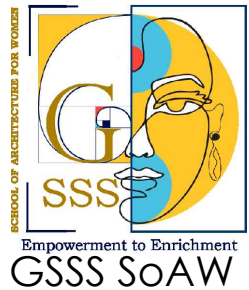

**Desirazu Associates**  
 Architecture      Planning      Interiors  
 #6, 6th Main, Paramahansa Road, Yadavgi, Mysore-570020  
 Mysore                  Chennai                  Muscat

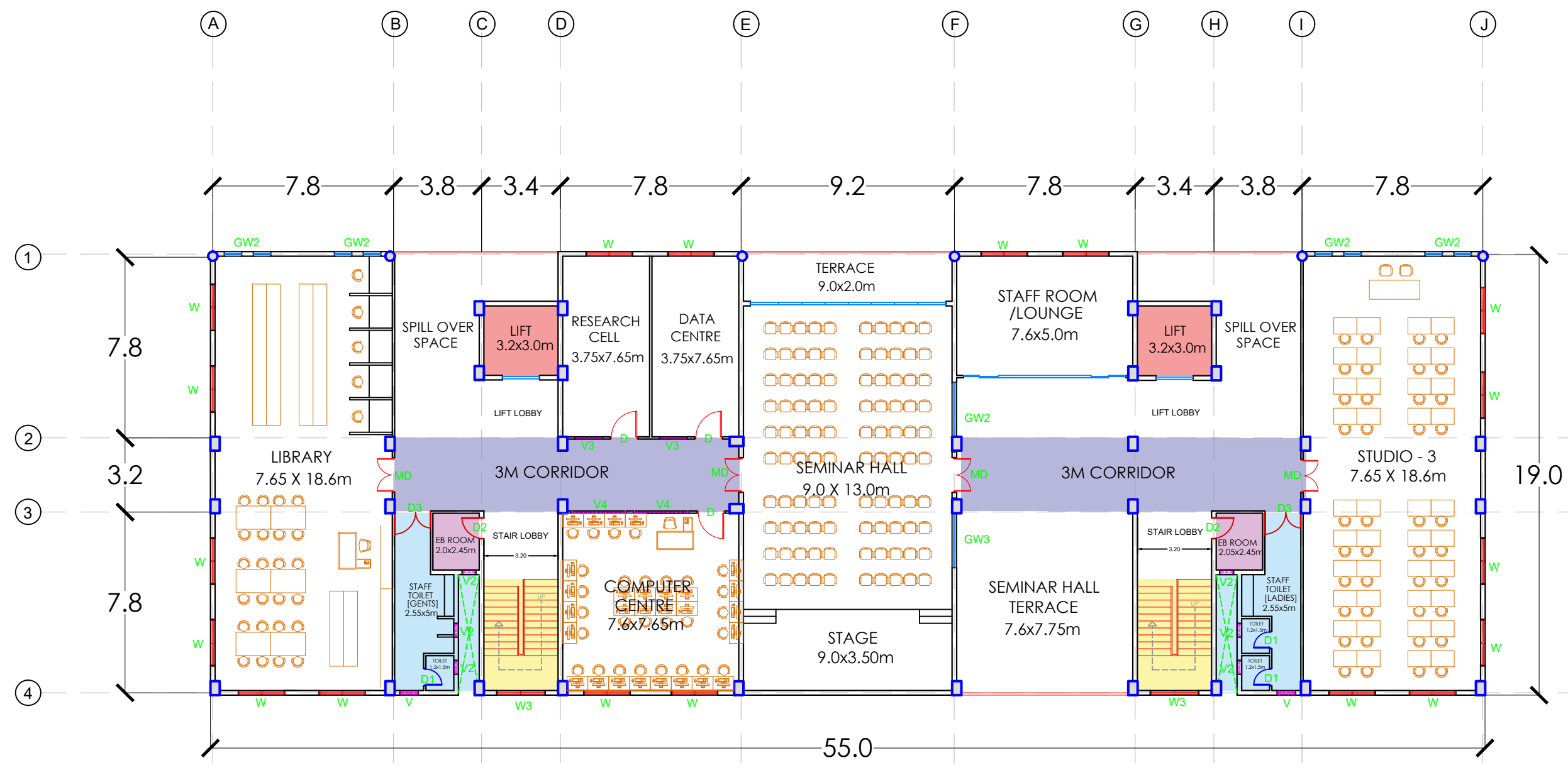
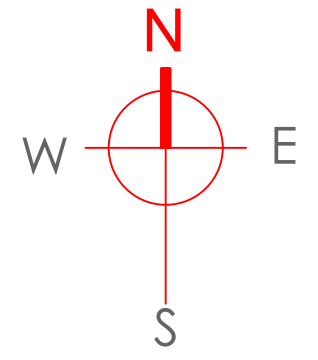

# SECOND FLOOR PLAN

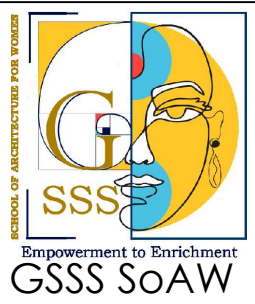

Architecture      Planning      Interiors  
#6,6th Main,Paramahamsa Road,Yadavgi, Mysore-570020  
Mysore                      Chennai                      Muscat









# VIEWS

**Desirazu Associates**

Architecture    Planning    Interiors  
#6, 6th Main, Paramahansa Road, Yadavgi, Mysore-570020

Mysore    Chennai    Muscat



# VIEWS

**Desirazu Associates**

Architecture    Planning    Interiors  
#6, 6th Main, Paramahansa Road, Yadavgiri,  
Mysore-570020

Mysore    Chennai    Muscat





# VIEWS





VIEWS



# SOAW - NORTH ELEVATION

## PROCESS OF DERIVING ELEVATION FROM ANCIENT STYLE OF ARCHITECTURE INCORPORATED INTO THE HERITAGE CITY OF MYSORE



**GRECO - ROMAN  
STYLE OF  
ARCHITECTURE**

**8th Century BC  
- 6th Century AD**

**Originated in  
Greece & Rome -  
Europe**

**RENAISSANCE  
STYLE OF  
ARCHITECTURE**

**Between  
early 15th &  
early 17th century**

**Originated in  
Italy - Europe**



**CRAWFORD HALL - 1947**



**KRISHNARAJENDRA HOSPITAL -  
1876 & rebuilt in 1918**



**RANGHACHARLU MEMORIAL HALL - 1884**



## FEATURES OF ELEVATION

**Desirazu Associates**  
Architecture Planning Interiors  
#6, 6th Main, Paramahansa Road, Yadavgiri,  
Mysore-570020  
Mysore Chennai Muscat

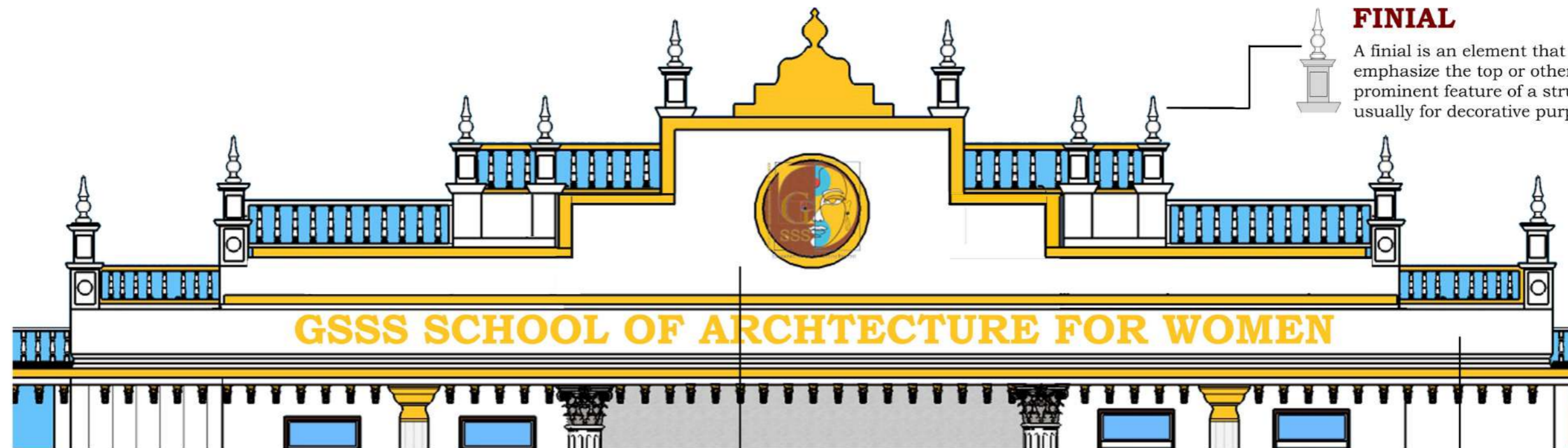

## FINIAL

A finial is an element that emphasize the top or other prominent feature of a structure, usually for decorative purposes.

## GRECO - ROMAN STYLE OF ARCHITECTURE

- **Emphasized  
Columns  
& pediments**

## STEPPED PEDIMENT

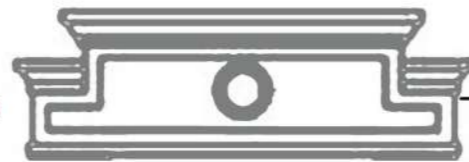

A pediment is an architectural element found particularly in Classical, Neoclassical and Baroque architecture, and it is placed above the horizontal structure or entablature, supported by columns.

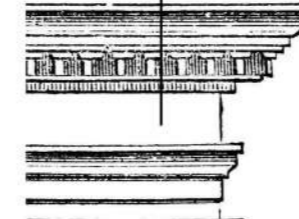

## ENTABULATURE

Entablature, is an assemblage of horizontal moldings and bands supported by and located immediately above the columns of Classical buildings

It includes cornices, frieze & architrave - long, narrow, horizontal panel or band used for decorative purposes

It sits on top of the column capitals, in between the architrave on the lowest level



**CRAWFORD HALL - 1947**



**KRISHNARAJENDRA HOSPITAL -**



**RANGHACHARLU MEMORIAL HALL - 1884**



# FEATURES OF ELEVATION

**Desirazu Associates**  
 Architecture Planning Interiors  
 #6, 6th Main, Paramahansa Road, Yadavgeri,  
 Mysore-570020  
 Mysore Chennai Muscat



### RENAISSANCE STYLE OF ARCHITECTURE

- Use of Classical Orders
- Use of mathematical ratios for height & width
- Emphasis on Symmetry, Proportion & Geometry



**CORINTHIAN COLUMN  
WITH FLUTES &  
TRAPEZOIDAL BASE**



### COMPOSITE ORDER

The capital is composed of Ionic volutes and Corinthian acanthus-leaf decoration.

A Roman Composite column combines the designs of the Greek Ionic and Corinthian columns. The capital top of a Roman Composite column has scrolls (volutes) and leaf decorations. Since the Renaissance, Composite column designs have been used in decorative pilasters.

### COLUMNS & PILASTERS

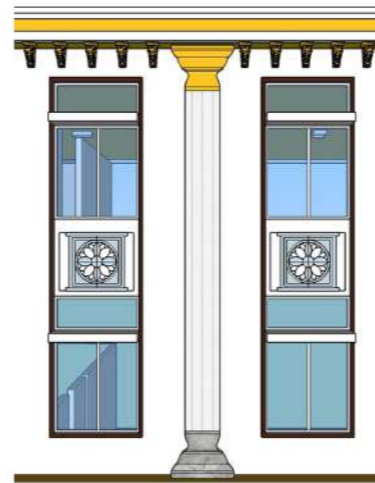

### TUSCAN ORDER

The Tuscan order is a Roman adaptation of the Doric. The Tuscan has an unfluted shaft and a simple echinus-abacus capital & It is similar in proportion and profile to the Roman Doric but is much plainer

Pilaster, in Greco-Roman Classical architecture, shallow rectangular column that projects slightly beyond the wall into which it is built and conforms precisely to the order or style of the adjacent columns.



### PILASTER WITH A GOLDEN TOP

### BALCONIES WITH BALUSTRADES

A balustrade is a row of small columns topped by a rail.

Rudolf Wittkower - the inventor of the baluster and credited Giuliano da Sangallo with using it consistently as early as the balustrade on the terrace and stairs at the Medici villa at Poggio a Caiano (c 1480), and used balustrades in his reconstructions of antique structures.

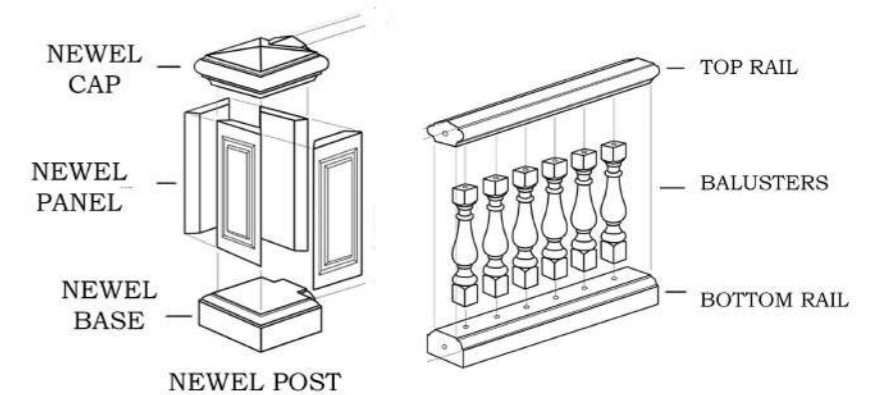
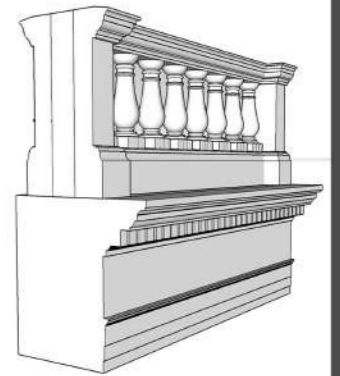

**LALITHA MAHAL PALACE - 1931**



**CHELUVAMBA VILAS PALACE - 1910**



**ROYAL ORCHID METROPOLE HOTEL - 1920**

## FEATURES OF ELEVATION